

SPECIFICATION

Light Type:	Rechargeable COB + SMD
Light Dimensions:	97 x 83 x 39mm
Weight of Light:	0.48 lbs. (218g)
Cordless/Corded:	Cordless
Charge Port Type, Micro USB:	TYPE C
On/Off, High/Low Switch Type:	Low (Flood), Mid (Flood), High (Flood), Spot-Off
Charger rating/type:	USB 5V1A or Wireless Charging Station (10W)
USB Cable Length/Type/Rating:	1M Type C USB cable
Main Plug Type, Amps, Volts:	US Plug 5V1A

GENERAL PERFORMANCE

Lumens:	Low (Flood-120lm), Mid (Flood-350lm), High (Flood-670lm), Spot-250lm
Viewing Angle (Beam Angle), degrees:	120°
Input Voltage, V:	5V
Electrical Rating, V /Hz:	3.7V, 50/60Hz

LIGHT TYPE

LED Quantity:	1COB + 1SMD
---------------	-------------

BATTERY

Battery, V, mAh:	3.7V 2600mAh
Time to Fully Charge, hours:	Home charger (4h), Wireless (4h)
Time to Fully Discharge, hours:	Low (Flood-10h), Middle (Flood-4.5h), High (Flood-2.5h), Spot-4.5h

PARTS BREAKDOWN

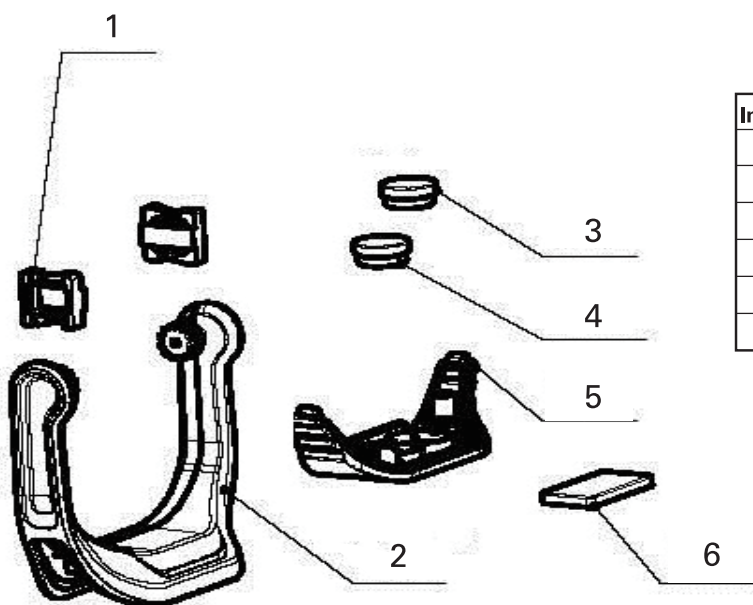

PARTS LIST

Index	Part No.	Description
1		"U" Nylon Stand
2		The Gear Holder
3		Magnet (N-pole)
4		Magnet (S-pole)
5		Magnet Base
6		Magnet Sticker